

VILLAGE OF QUEEN CHARLOTTE
HONNA RIVER WATER SUPPLY
WATER TREATMENT PLANT

CONTRACT No. 163.8.4.2

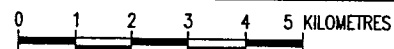

ISSUED FOR TENDER

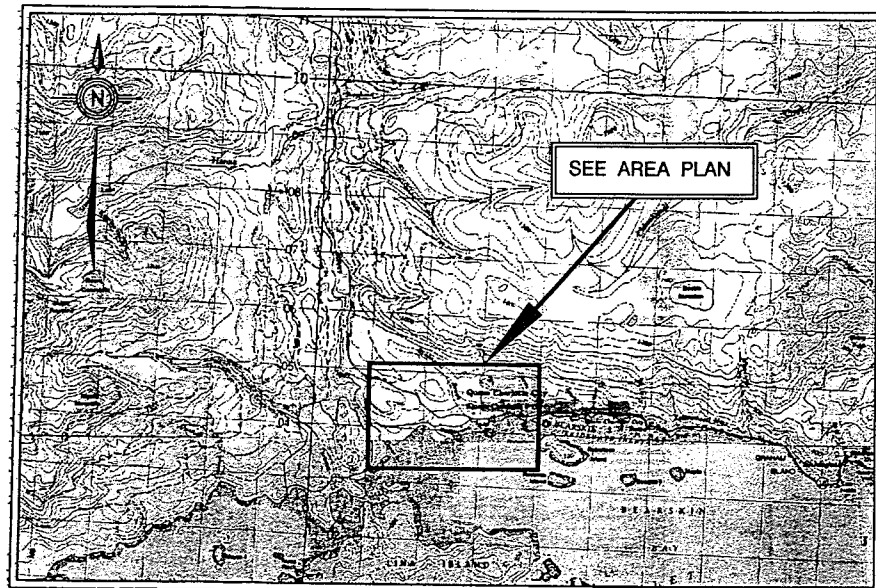

LOCATION PLAN

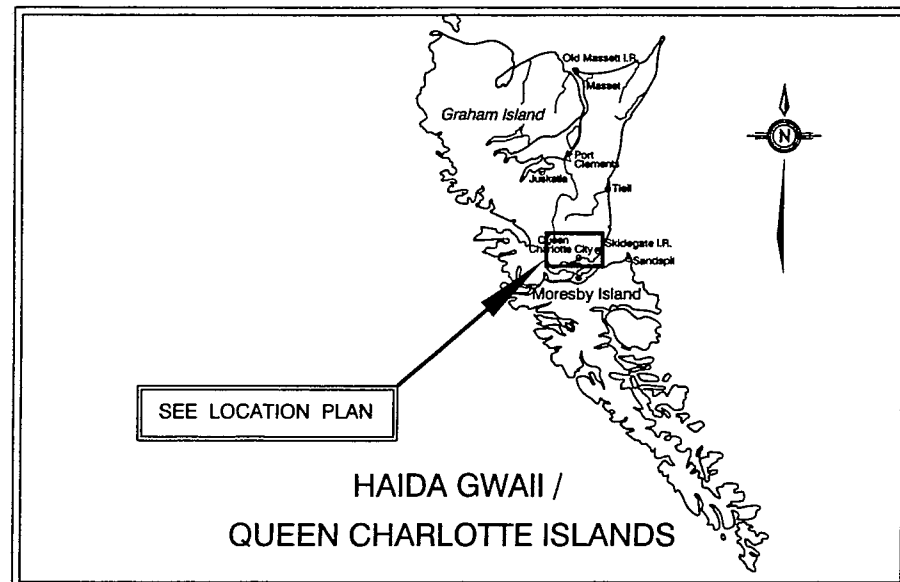

HAIDA GWAI /
QUEEN CHARLOTTE ISLANDS

KEY PLAN
NTS

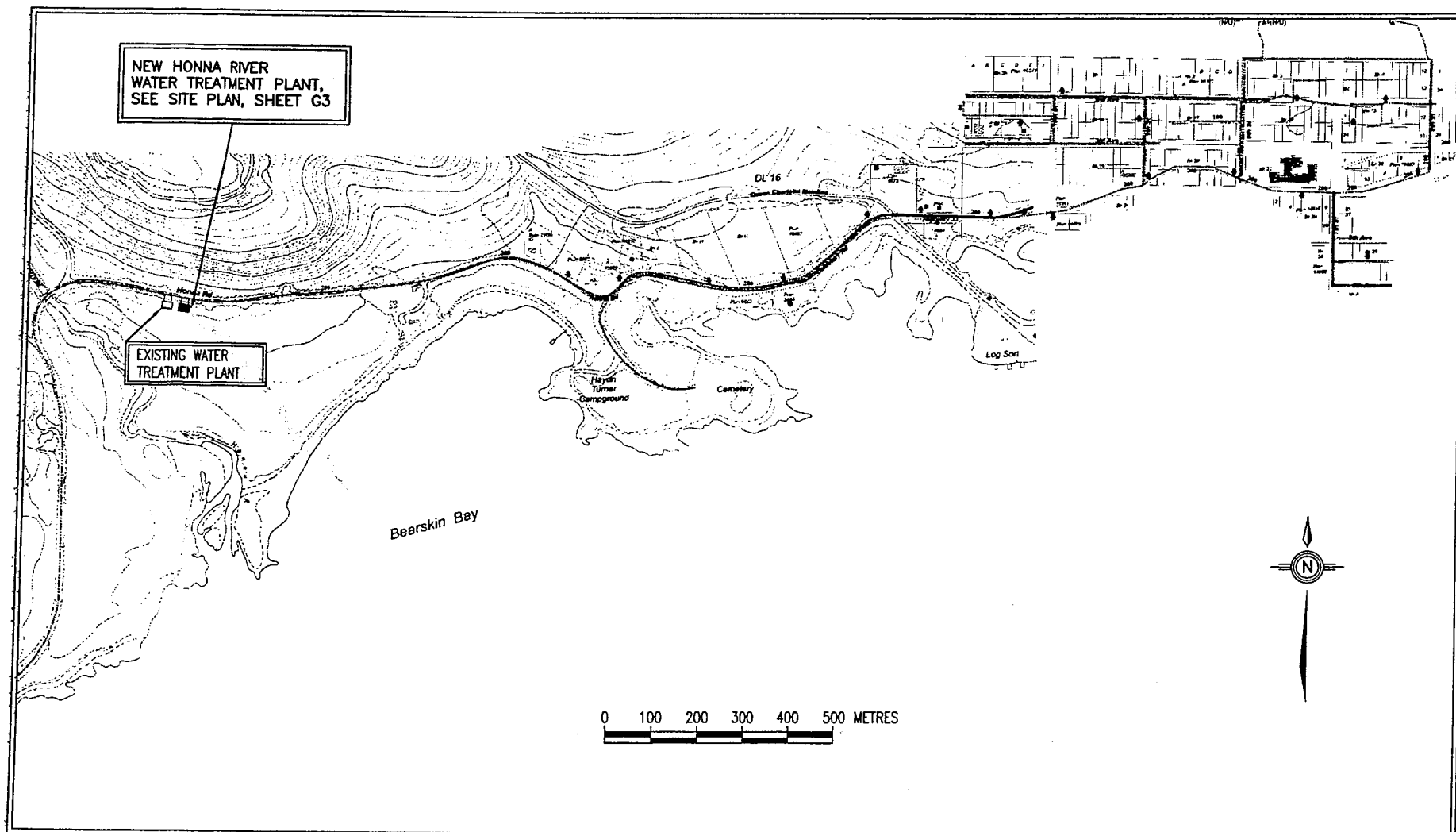

AREA PLAN

INDEX TO DRAWINGS (TOTAL DWGS. = 56)

SHEET No.	TITLE
GENERAL	
G1	KEY PLAN - LOCATION PLAN - AREA PLAN - INDEX TO DRAWINGS
G2	HYDRAULIC PROFILE
G3	SITE LAYOUT
G4	SITE GRADING
G5	SITE SECTIONS
G6	SITE SECTIONS
G7	SITE SECTIONS
G8	OUTSIDE PIPING
G9	SITE SECTIONS
G10	PIPING PROFILES
G11	DETAILS
PROCESS AND INSTRUMENTATION	
P1	P&ID STANDARD TAGS AND ABBREVIATIONS
P2	P&ID STANDARD SYMBOLS, EQUIPMENT, VALVES AND INSTRUMENTATION
P3	PROCESS SCHEMATIC
P4	P&ID - RAW WATER PRE-TREATMENT
P5	P&ID - DAF TREATMENT - TRAIN No.1
P6	P&ID - DAF TREATMENT - TRAIN No.2
P7	P&ID - CLEARWELL
P8	P&ID - DISINFECTION AND POST TREATMENT
P9	P&ID - CHEMICAL FEED SYSTEMS - COAGULANT AND POLYMER
P10	P&ID - CAUSTIC SYSTEM AND BACKWASH RESIDUALS STORAGE TANK
P11	P&ID - CHLORINATION SYSTEM
P12	P&ID - DAF RECYCLE PUMPS AND BLOWERS
ARCHITECTURAL	
A1	BUILDING ELEVATIONS
STRUCTURAL	
S1	GENERAL CONSTRUCTION NOTES
S2	GENERAL STRUCTURAL DETAILS
S3	GENERAL STRUCTURAL AND MASONRY DETAILS
S4	CONCRETE OUTLINE - FLOOR PLAN
S5	CONCRETE OUTLINE - SECTIONS
S6	FRAMING DETAILS - INTERIOR ROOMS
S7	BACKWASH RESIDUALS SETTLING TANK - PLAN - SECTIONS
S8	REINFORCING - SECTIONS
S9	REINFORCING - SECTIONS
S10	REINFORCING - BACKWASH TANK - PLAN - SECTIONS
MECHANICAL	
M1	MECHANICAL - FLOOR PLAN
M2	MECHANICAL - SECTIONS
M3	MECHANICAL - SCHEMATICS AND BILL OF MAJOR MATERIALS
M4	MECHANICAL - BACKWASH TANK - PLAN - SECTION
M5	MECHANICAL - MISCELLANEOUS DETAILS
HEATING AND VENTILATING	
HV1	HVAC - SCHEDULES - STANDARD DETAILS
HV2	HVAC - FLOOR PLAN
ELECTRICAL	
E1	ELECTRICAL - SITE PLAN
E2	ELECTRICAL - MCC LAYOUT AND SINGLE LINE DIAGRAM
E3	ELECTRICAL - FILTER No.1 & No.2 - MIXER, FLOCCULATORS AND SCUM SCRAPER WIRING DIAGRAM AND PANEL LAYOUT
E4	ELECTRICAL - CLARIFICATION BASIN POND SUMP PUMPS AND VALVES WIRING DIAGRAM AND PANEL LAYOUT
E5	ELECTRICAL - ACL AND ADJUSTABLE SPEED DRIVE WIRING DIAGRAM
E6	ELECTRICAL - CABLE TRAY LAYOUT
E7	ELECTRICAL - LIGHTING AND UTILITY LAYOUT
E8	ELECTRICAL - POWER AND CONTROL LAYOUT
E9	ELECTRICAL - PANELBOARD SCHEDULE AND MISCELLANEOUS ELECTRICAL DETAILS
E10	ELECTRICAL - CABLE SCHEDULE
E11	ELECTRICAL - CABLE SCHEDULE - VENDOR SUPPLIED EQUIPMENT
E12	ELECTRICAL - PLC I/O WIRING DIAGRAM - PAGE 1
E13	ELECTRICAL - PLC I/O WIRING DIAGRAM - PAGE 2
E14	ELECTRICAL - WTP MAIN PLC LAYOUT, CONTROL POWER OVERVIEW
E15	WORKS YARD PLC PANEL LAYOUT AND CONTROL POWER OVERVIEW
E15	ELECTRICAL - COMMUNICATION ARCHITECTURE

VILLAGE OF QUEEN CHARLOTTE
HONNA RIVER WATER SUPPLY - WATER TREATMENT PLANT
CONTRACT No. 163.8.4.2

FILE: P:\Drawing\QUEEN - CHARLOTTE\163-8-4-2\GENERAL\163-8-4-2_G1.dwg Tcb G1 09-03-19 DCURTIS

ISSUE	DATE	DRAWN	CHK'D	APP'D	DESCRIPTION
A	MAR20/09	DBC	CC	CB	ISSUED FOR TENDER

DESIGNED CB
 DRAWN DBC
 CHECKED CC



VILLAGE OF QUEEN CHARLOTTE
 HONNA RIVER WATER SUPPLY - WATER TREATMENT PLANT
 KEY PLAN - LOCATION PLAN - AREA PLAN - INDEX TO DRAWINGS

SCALE: AS SHOWN
DRAWING No. 163.8.4.2
SHEET No. G1 ISSUE A
THIS DRAWING REDUCED TO HALFSIZE

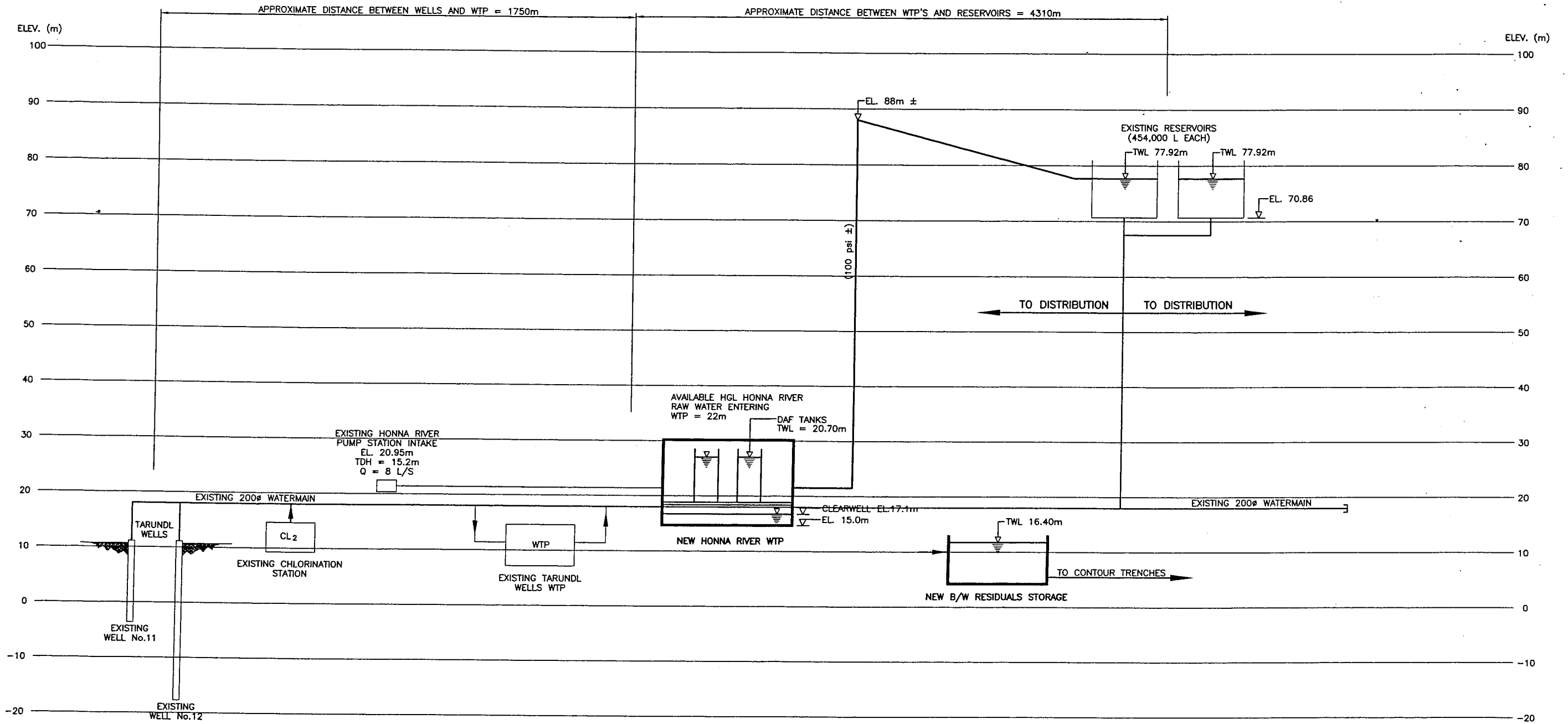

HYDRAULIC PROFILE
NTS

NOTES :

1. TARUNDL WELLS PRODUCTION CAPACITY 687m³/d (1992, PITEAU). SUSTAINING FLOWS 500m³/d (2002, PITEAU).
2. DAF TANKS FINAL TWL TO BE DETERMINED FROM EQUIPMENT SHOP DRAWINGS.
3. ELEVATION ZERO DATUM. CANADIAN HYDROGRAPHIC SERVICES.

NOTE :

INFORMATION ON THIS DRAWING IS ADAPTED FROM NUMEROUS SOURCES, INCLUDING McELHANNEY CONSULTING SERVICES LTD. JOB No. 2321-00363 DRAWING No.1 TARUNDL CREEK WATER TREATMENT PLANT SUPPLY SCHEMATIC (1998). PITEAU REPORT (NOVEMBER 20, 2002, FILE 2386), DAYTON & KNIGHT FILE 163.3.7, DRAWING, SHEET 4, DAYTON & KNIGHT FILE 163.8.6, DRAWING, SHEET G2.

FILE: P:\Drawings\QUEEN - CHARLOTTE\163-8-4-2\GENERAL\163-8-4-2_G2.dwg, Job G2 09-03-18 DCURTISS

PLOT: FULL 1:1 HALF 1:2

ISSUE	DATE	DRAWN	CHK'D	APP'D	DESCRIPTION
A	MAR20/05	DBC	CC	CB	ISSUED FOR TENDER

DESIGNED CB
 DRAWN DBC
 CHECKED CC

Dayton & Knight Ltd.
 CONSULTING ENGINEERS
#210-869 HARBOURSIDE DR., NORTH VANCOUVER, B.C. V7P 3S1
 TEL: (604) 990-4800 FAX: (604) 990-4805 www.dayton-knight.com

VILLAGE OF QUEEN CHARLOTTE
 HONNA RIVER WATER SUPPLY - WATER TREATMENT PLANT
 HYDRAULIC PROFILE

SCALE: AS SHOWN		
DRAWING No. 163.8.4.2		
SHEET No.	G2	ISSUE A
THIS DRAWING REDUCED TO HALFSIZE		

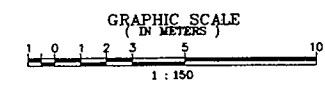
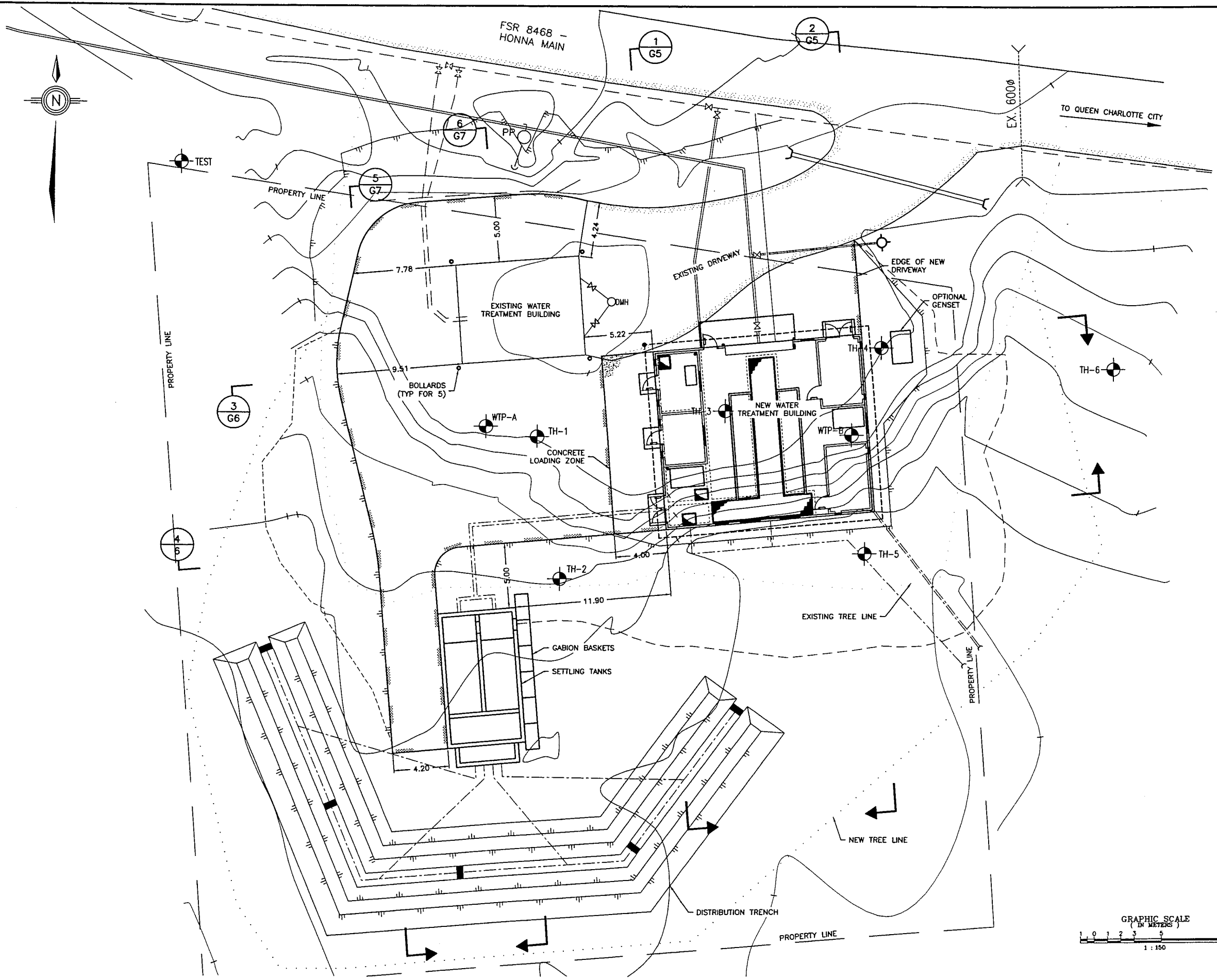
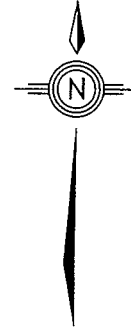

FILE: P:\Drawing\QUEEN - CHARLOTTE\163-8-4-2\GENERAL\163.8.4-WTP_G3-G11 - CIVIL3D-2009.dwg, Tsb G3 G3-G11 - DCJURISS
 DCJURISS
 09-03-19

PLOT: FULL 1:1 HALF 1:2

ISSUE	DATE	DRAWN	CHK'D	APP'D	DESCRIPTION	ISSUE	DATE	DRAWN	CHK'D	APP'D	DESCRIPTION
A	MAR/09	JE	PW	CB	ISSUED FOR TENDER						

DESIGNED PW
 DRAWN JE
 CHECKED PW

Dayton & Knight Ltd.
 CONSULTING ENGINEERS
 #210-889 HARBOURSIDE DR., NORTH VANCOUVER, B.C. V7P 3S1
 TEL: (604) 990-4800 FAX: (604) 990-4805 www.dayton-knight.com

VILLAGE OF QUEEN CHARLOTTE
 HONNA RIVER WATER SUPPLY - WATER TREATMENT PLANT
 SITE LAYOUT

SCALE: 1:150		
DRAWING No. 163.008.004		
SHEET No.	G3	ISSUE A
THIS DRAWING REDUCED TO HALFSIZE		

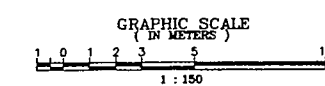
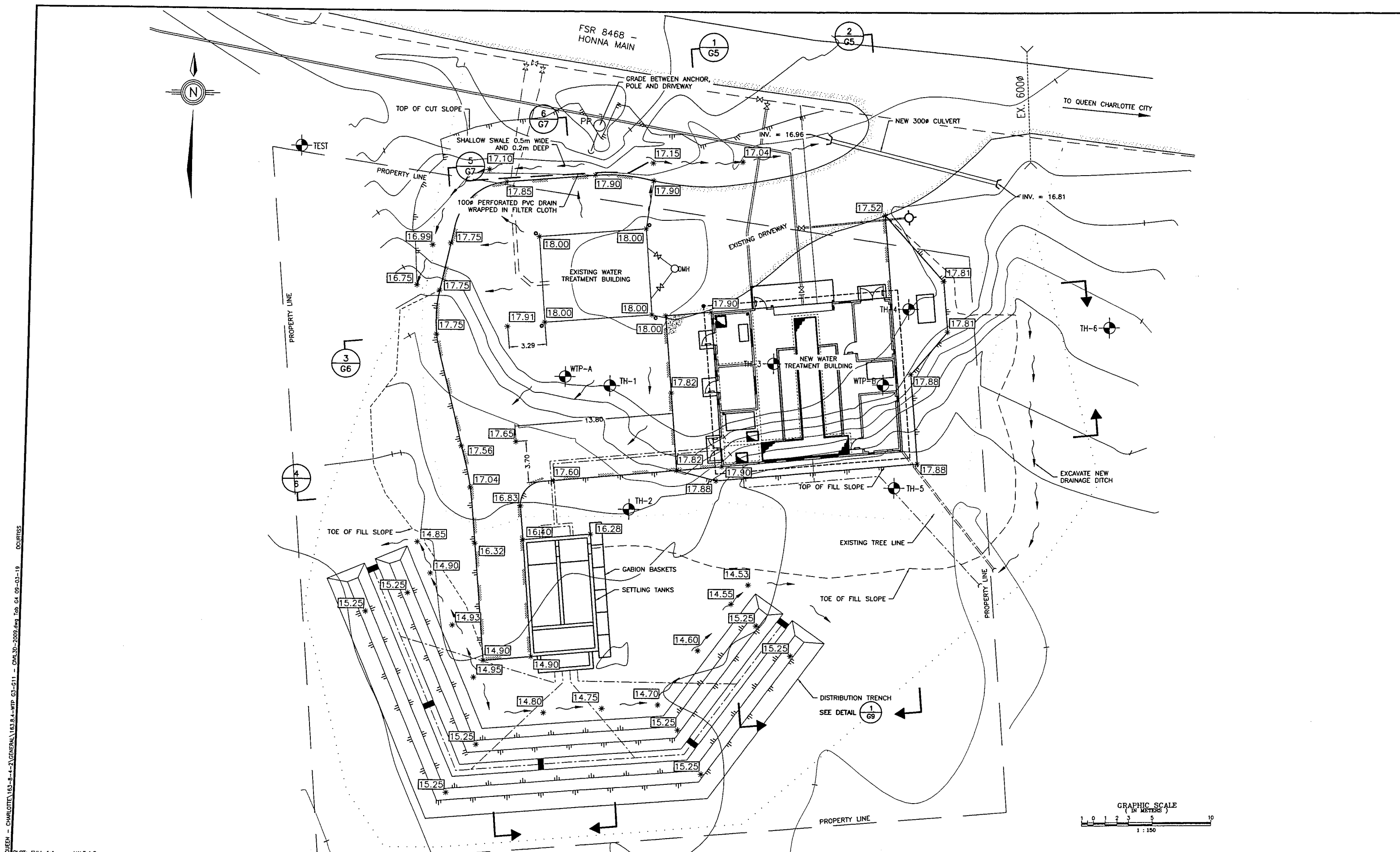

FILE: P:\Drawings\QUEEN - CHARLOTTE\163-8-4-2\GENERAL\163.8.4-WTP G3-G11 - CML3D-2009.dwg Tab: G4 09-03-19 DCURTIS

PLOT: FULL 1:1 HALF 1:2

ISSUE	DATE	DRAWN	CHK'D	APP'D	DESCRIPTION
A	MAR20/08	JE	PW	CB	ISSUED FOR TENDER

ISSUE	DATE	DRAWN	CHK'D	APP'D	DESCRIPTION

DESIGNED PW
 DRAWN JE
 CHECKED PW

Dayton & Knight Ltd.
 CONSULTING ENGINEERS
 #210-889 HARBOURSIDE DR., NORTH VANCOUVER, B.C. V7P 3S1
 TEL: (604) 940-4800 FAX: (604) 940-4805 www.dayton-knight.com

VILLAGE OF QUEEN CHARLOTTE
 HONNA RIVER WATER SUPPLY - WATER TREATMENT PLANT
 SITE GRADING

SCALE: 1:150
DRAWING No. 163.008.004
SHEET No. G4 ISSUE A
THIS DRAWING REDUCED TO HALFSIZE

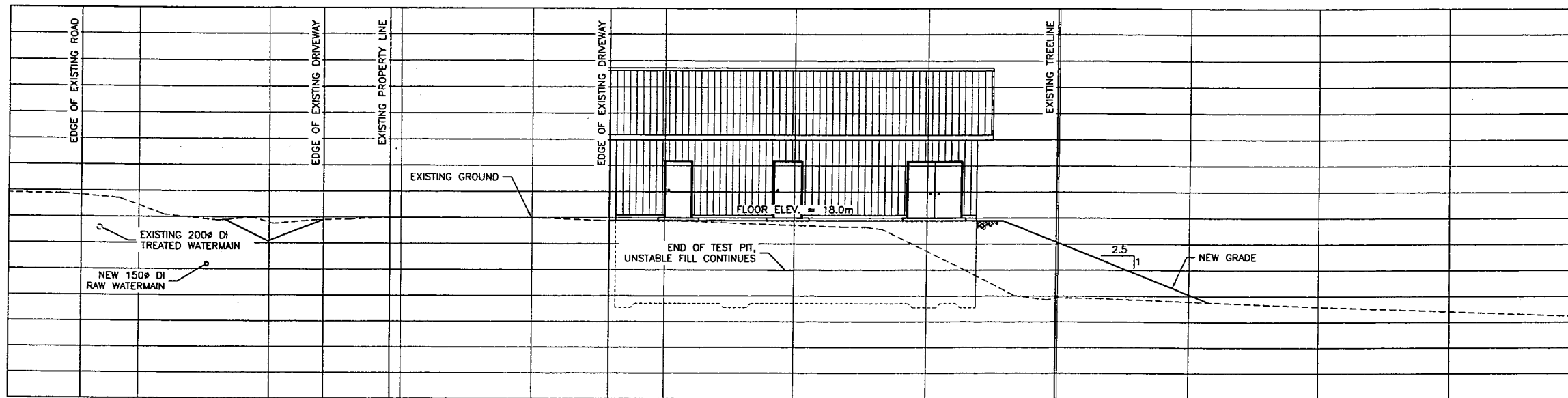

SECTION 1
G3

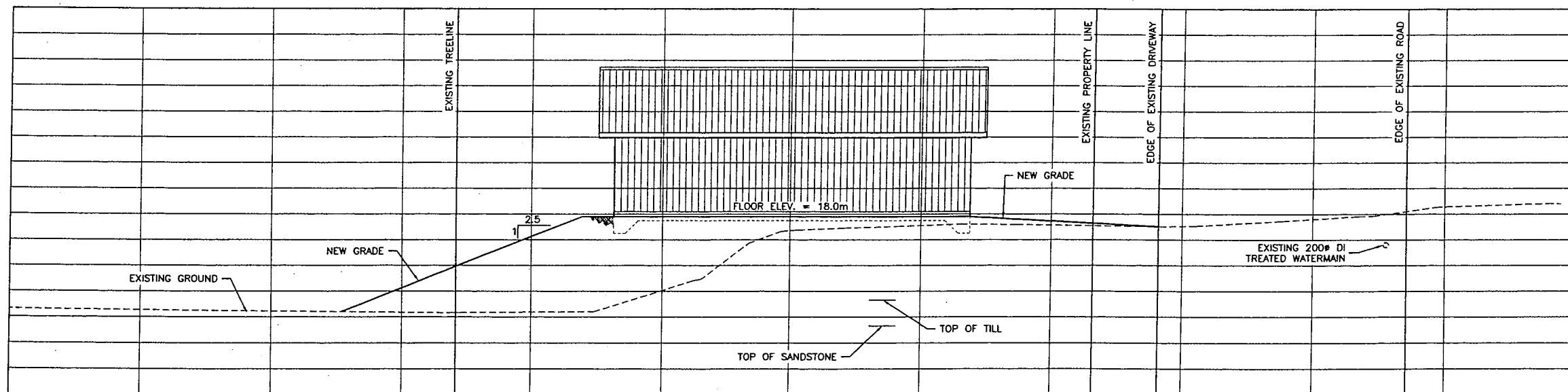

SECTION 2
G3

FILE: P:\Drawings\QUEEN - CHARLOTTE\163-8-4-2\GENERAL\163.B.4-WTP-G3-G11 - CIVIL3D-2009.dwg Tab: G5 08-03-19 00:00:55

ISSUE	DATE	DRAWN	CHK'D	APP'D	DESCRIPTION
A	MAR20/09	JE	PW	CB	ISSUED FOR TENDER

DESIGNED PW
 DRAWN JE
 CHECKED PW



Dayton & Knight Ltd.
 CONSULTING ENGINEERS
#210-889 HARBOURSIDE DR., NORTH VANCOUVER, B.C. V7P 3S1
 TEL: (604) 990-4800 FAX: (604) 990-4805 www.dayton-knight.com

VILLAGE OF QUEEN CHARLOTTE
 HONNA RIVER WATER SUPPLY - WATER TREATMENT PLANT
 SITE SECTIONS

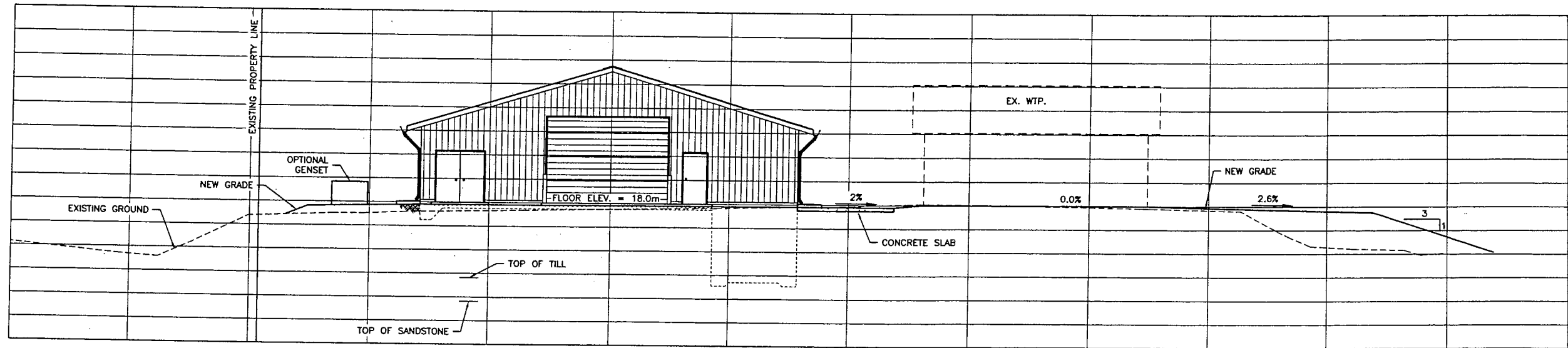
SCALE: 1:100
 DRAWING No. 163.008.004
 SHEET No. G5 ISSUE A
 THIS DRAWING REDUCED TO HALFSIZE

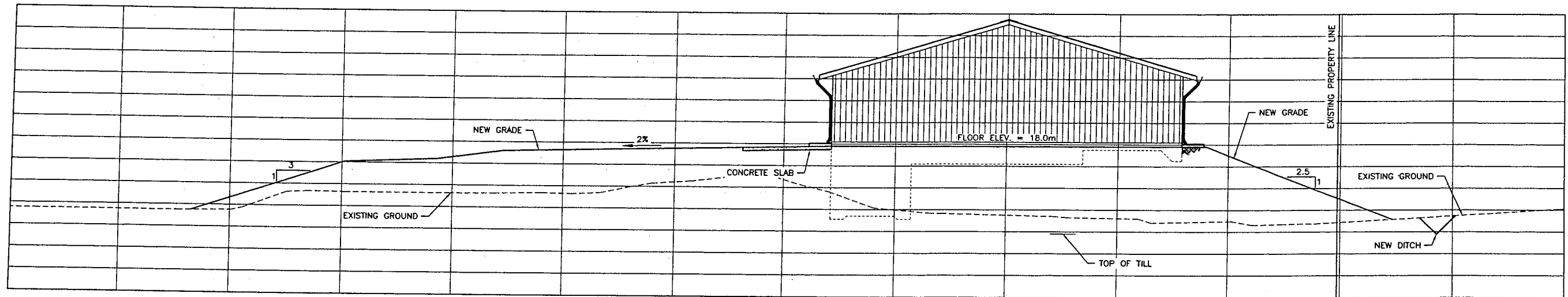

SECTION $\frac{3}{G3}$



SECTION $\frac{4}{G3}$

FILE: P:\Drawings\QUEEN - CHARLOTTE\163-B-4-2\GENERAL\163.B.4-WTP G3-G11 - CMLD-2009.dwg, Tab: G6, 09-03-19, DCURTIS

PLOT: FULL 1:1 HALF 1:2

ISSUE	DATE	DRAWN	CHK'D	APP'D	DESCRIPTION	ISSUE	DATE	DRAWN	CHK'D	APP'D	DESCRIPTION
A	MAR20/05	JE	PW	CB	ISSUED FOR TENDER						

DESIGNED PW
 DRAWN JE
 CHECKED PW



Dayton & Knight Ltd.
 CONSULTING ENGINEERS
 #210-809 HARBOURSIDE DR., NORTH VANCOUVER, B.C. V7P 3S1
 TEL: (604) 960-4800 FAX: (604) 960-4805 www.dayton-knight.com

VILLAGE OF QUEEN CHARLOTTE
 HONNA RIVER WATER SUPPLY - WATER TREATMENT PLANT
 SITE SECTIONS

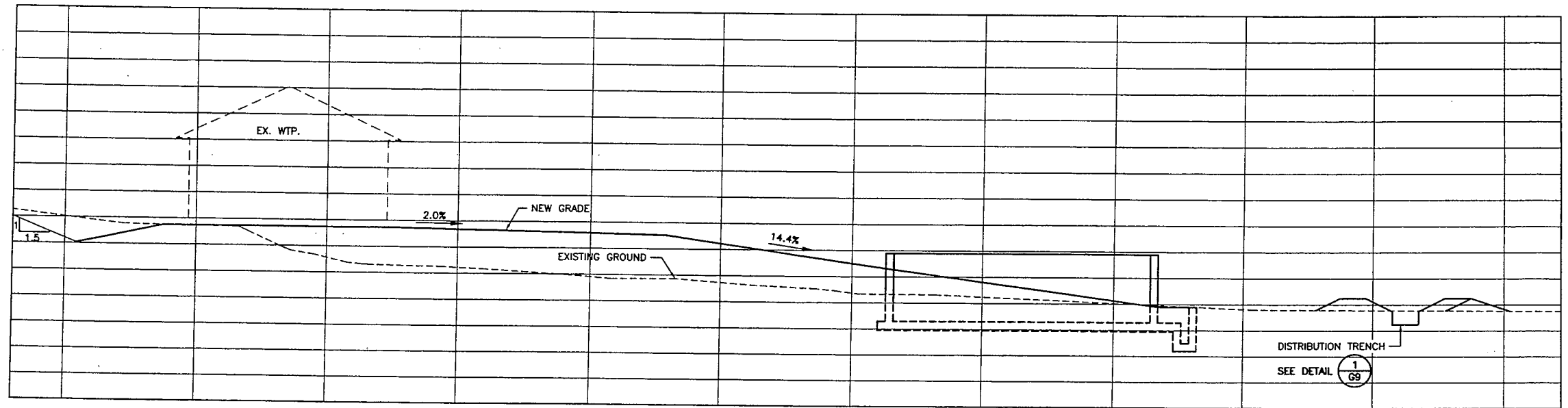
SCALE: 1:100
 DRAWING No. 163.008.004
 SHEET No. G6 ISSUE A
 THIS DRAWING REDUCED TO HALFSIZE

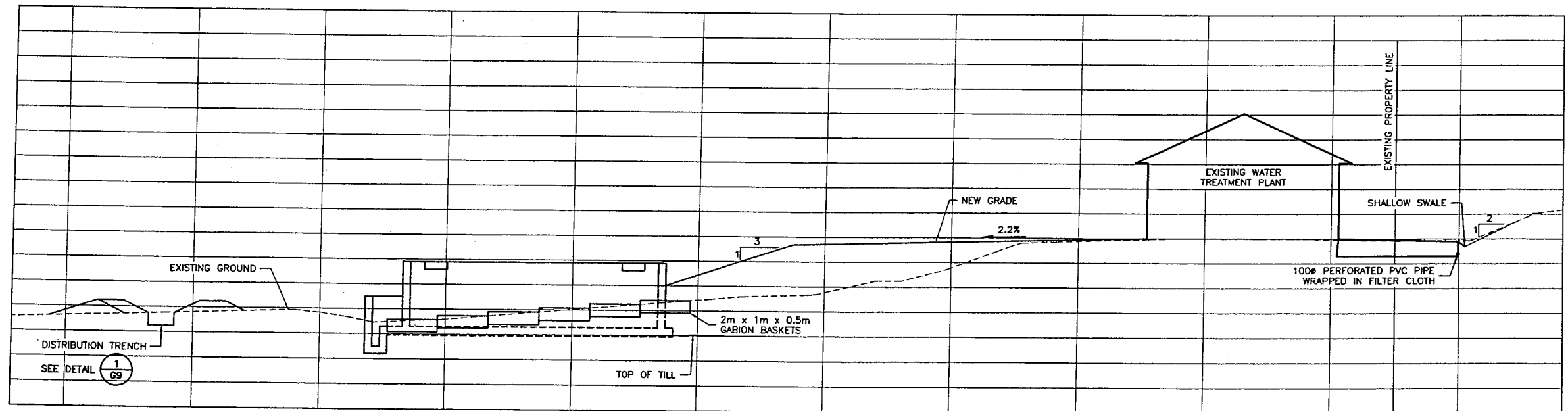

SECTION 5
G3



SECTION 6
G3

FILE: P:\Drawing\QUEEN - CHARLOTTE\163-B-4-2\GENERAL\163.B.4-WTP G3-G11 - CML30-2009.dwg, Job: G7 09-03-19, DCURISS

PLOT: FULL 1:1 HALF 1:2

ISSUE	DATE	DRAWN	CHK'D	APP'D	DESCRIPTION	ISSUE	DATE	DRAWN	CHK'D	APP'D	DESCRIPTION
A	MAR2009	JE	PW	CB	ISSUED FOR TENDER						

DESIGNED PW
 DRAWN JE
 CHECKED PW



Dayton & Knight Ltd.
 CONSULTING ENGINEERS
#210-880 HARBORSIDE DR., NORTH VANCOUVER, B.C. V7P 3S1
 TEL: (604) 990-4800 FAX: (604) 990-4805 www.dayton-knight.com

VILLAGE OF QUEEN CHARLOTTE
 HONNA RIVER WATER SUPPLY - WATER TREATMENT PLANT
 SITE SECTIONS

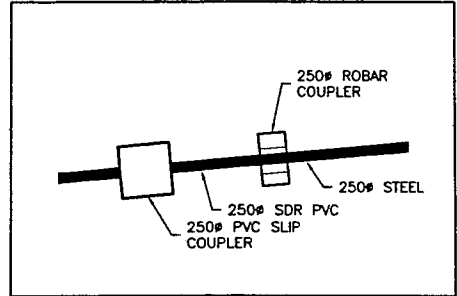
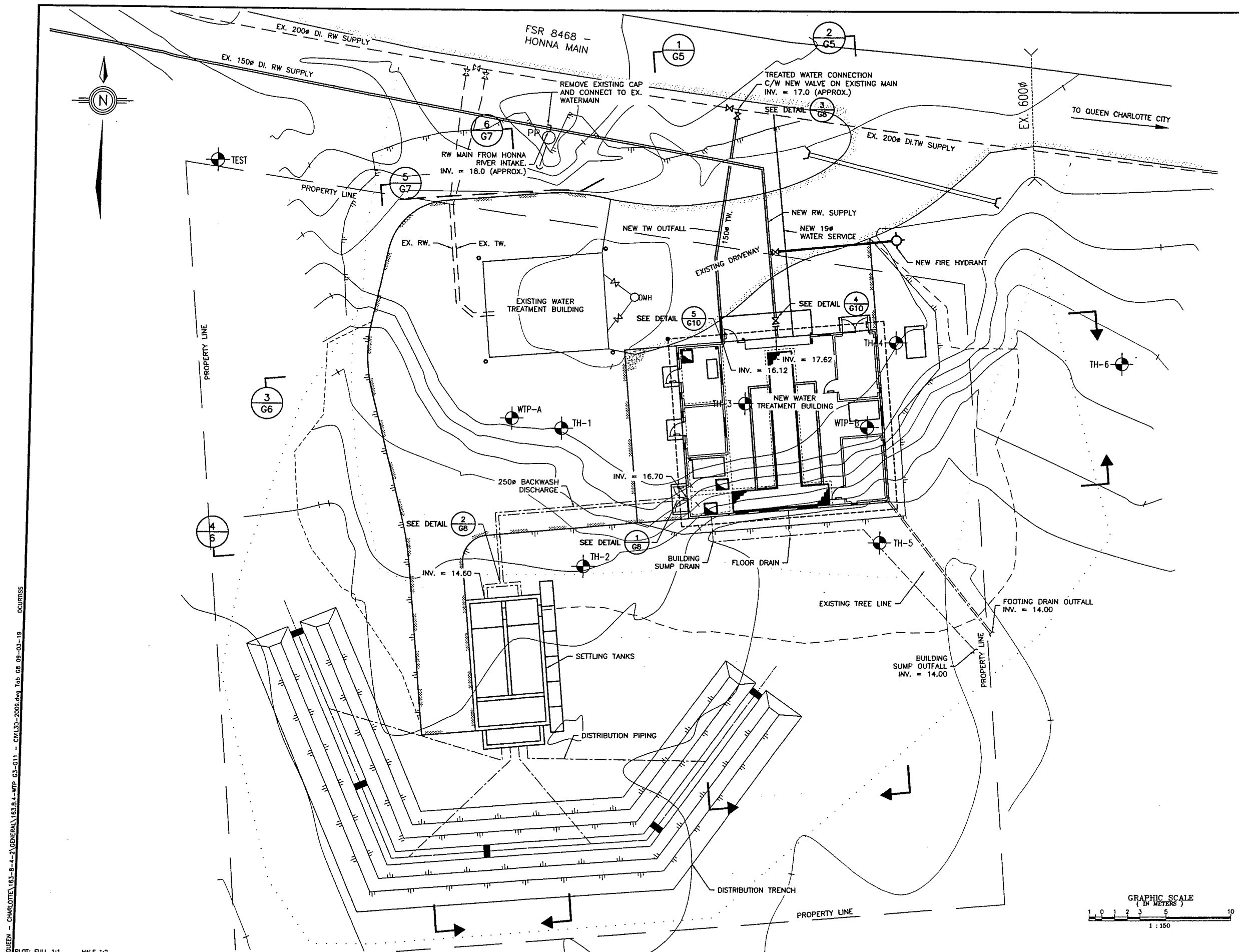
SCALE: 1:100
 DRAWING No. 163.008.004
 SHEET No. G7 ISSUE A
 THIS DRAWING REDUCED TO HALFSIZE

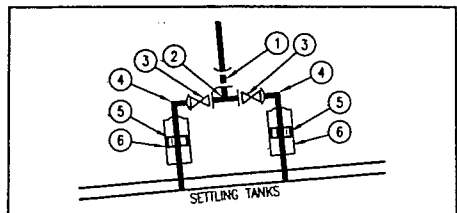

SEE DETAIL 1 G8
NTS



- ① 1 - 250# SDR TO C300 ADAPTOR
- ② 1 - 250# TEE
- ③ 2 - 250# FLG. x HUB GATE VALVE
- ④ 2 - 250# HUB x HUB 90° BEND
- ⑤ 2 - 250# ROBAR COUPLER
- ⑥ 2 - 250# FLEX JOINT

SEE DETAIL 2 G8
NTS

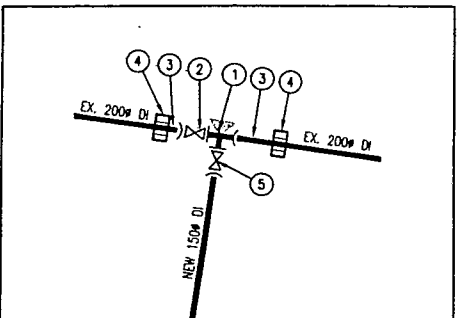

- ① 1 - 200# FLG. x 200# HUB x 150# FLG. TEE c/w THRUST BLOCK
- ② 1 - 200# HUB x FLG. GATE VALVE
- ③ 2 - 200# DI SPOOL
- ④ 2 - 200# ROBAR COUPLING
- ⑤ 1 - 150# HUB x FLG. GATE VALVE

SEE DETAIL 3 G8
NTS

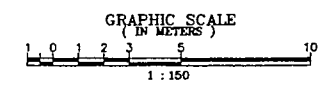

FILE: P:\Drawing\QUEEN - CHARLOTTE\163-8-4-2\GENERAL\163.8.4-WTP G3-G11 - CIVIL3D-2008.dwg, Job: G3, 09-03-19
 D:\Drawing\QUEEN - CHARLOTTE\163-8-4-2\GENERAL\163.8.4-WTP G3-G11 - CIVIL3D-2008.dwg, Job: G3, 09-03-19
 PLOT: FULL 1:1 HALF 1:2

ISSUE	DATE	DRAWN	CHK'D	APP'D	DESCRIPTION	ISSUE	DATE	DRAWN	CHK'D	APP'D	DESCRIPTION
A	MAR20/09	JE	PW	CB	ISSUED FOR TENDER						

DESIGNED PW
 DRAWN JE
 CHECKED PW

Dayton & Knight Ltd.
 CONSULTING ENGINEERS
 #210-880 HARBORSIDE DR., NORTH VANCOUVER, B.C. V7P 3S1
 TEL: (604) 990-4800 FAX: (604) 990-4805 www.dayton-knight.com

VILLAGE OF QUEEN CHARLOTTE
 HONNA RIVER WATER SUPPLY - WATER TREATMENT PLANT
 OUTSIDE PIPING

SCALE: 1:150

DRAWING No. 163.008.004		
SHEET No.	G8	ISSUE A
THIS DRAWING REDUCED TO HALFSIZE		

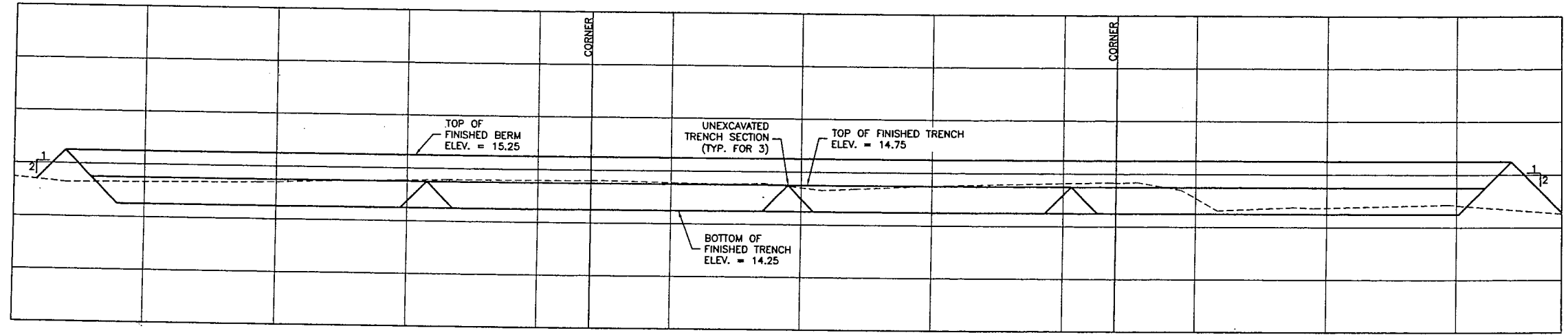

DISTRIBUTION TRENCH PROFILE
SCALE: (H) 1:100 (V) 1:50

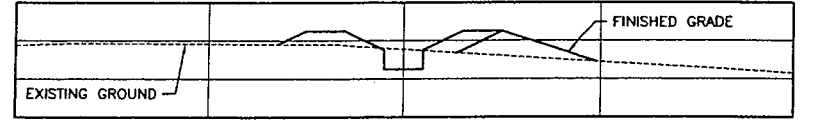
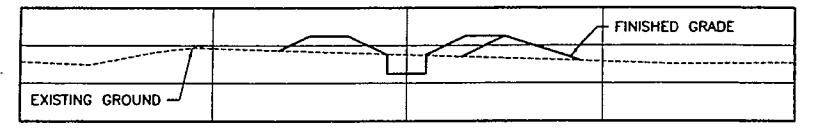
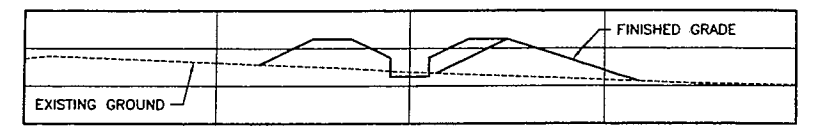
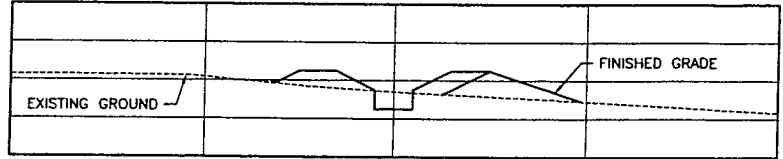
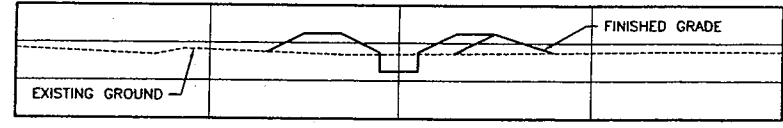
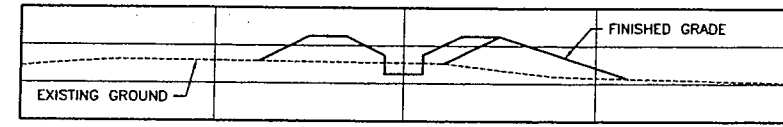
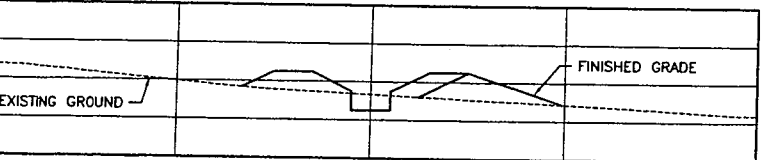
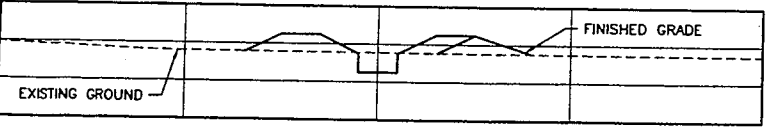
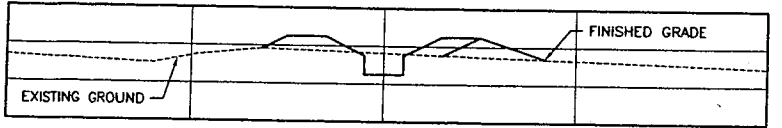
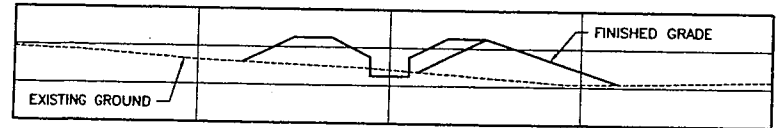
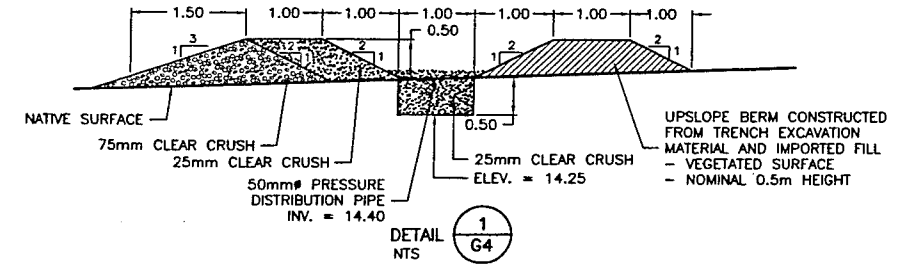

DISTRIBUTION TRENCH SECTIONS
SCALE: (H) 1:100 (V) 1:100

FILE: P:\Drawings\QUEEN - CHARLOTTE\163-B-4-2\GENERAL\163.B-4-WTP-G3-G11 - CIVIL3D-2009.dwg Tab 09 09-03-10 OCLRTSS
 AutoCAD DRAWING
 PLOT: FULL 1:1 HALF 1:2

REVISIONS	ISSUE	DATE	DRAWN	CHK'D	APP'D	DESCRIPTION	ISSUE	DATE	DRAWN	CHK'D	APP'D	DESCRIPTION
A	MAR20/09	JE	PW	CB		ISSUED FOR TENDER						

DESIGNED PW
 DRAWN JE
 CHECKED PW

Dayton & Knight Ltd.
 CONSULTING ENGINEERS
 #210-889 HARBOURSIDE DR., NORTH VANCOUVER, B.C. V7P 3S1
 TEL: (604) 990-4800 FAX: (604) 990-4805 www.dayton-knight.com

VILLAGE OF QUEEN CHARLOTTE
 HONNA RIVER WATER SUPPLY - WATER TREATMENT PLANT
 SITE SECTIONS

SCALE: 1:100		
DRAWING No. 163.008.004		
SHEET No.	G9	ISSUE A
THIS DRAWING REDUCED TO HALFSIZE		

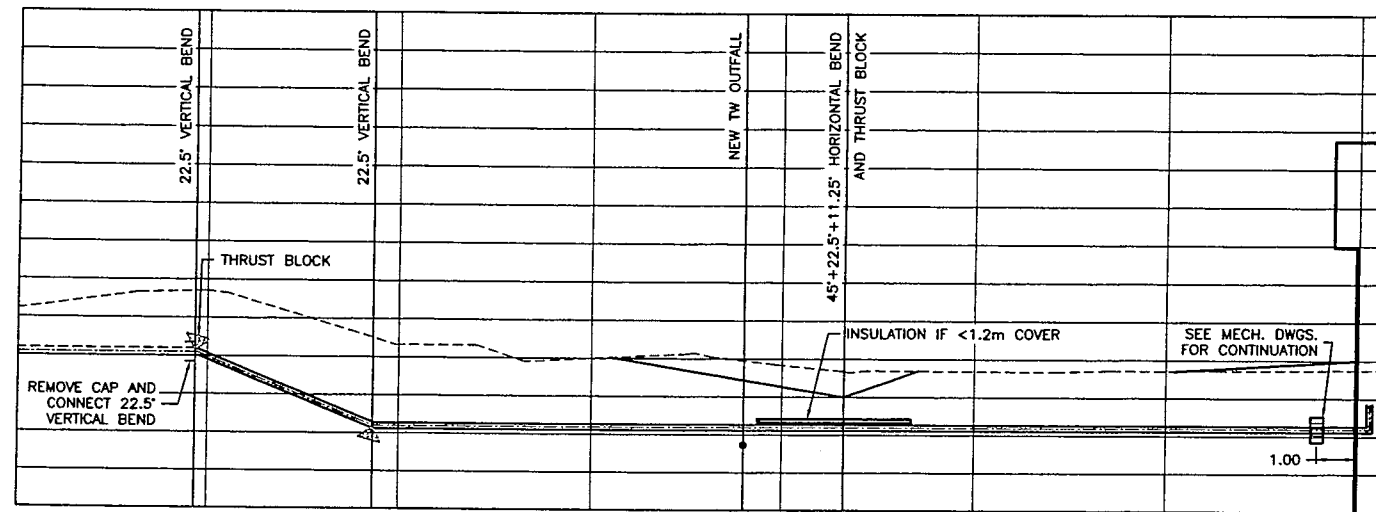

PROFILE - NEW 150 ϕ RAW WATERMAIN

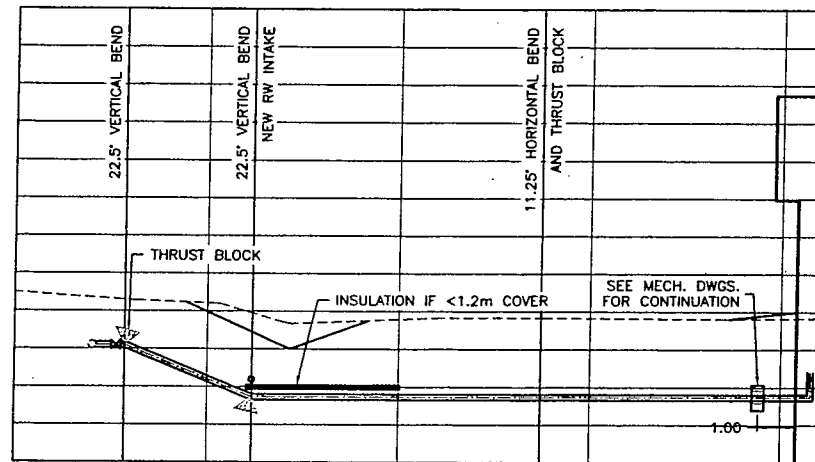

PROFILE - NEW 150 ϕ TREATED WATERMAIN

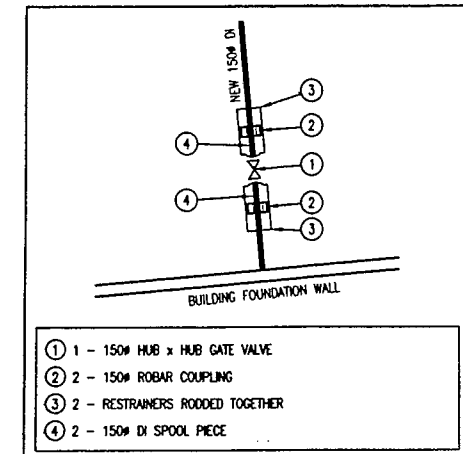

SEE DETAIL $\frac{4}{G8}$
NTS

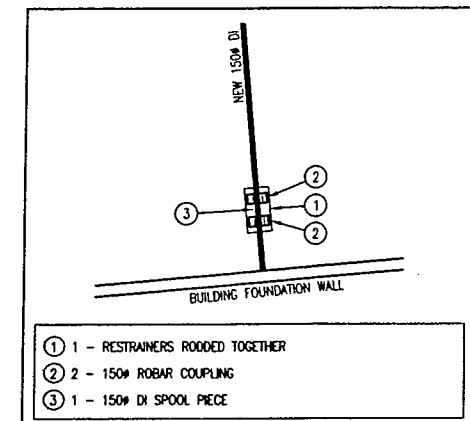

SEE DETAIL $\frac{5}{G8}$
NTS

FILE: P:\Projects\QUEEN - CHARLOTTE\163-8-4-2\GENERAL\163.8.4-WTP G3-G11 - CML3D-2009.dwg Tab G10 09-03-19 DCURTISS

PLOT: FULL 1:1 HALF 1:2

AutoCAD
DRAWING

ISSUE	DATE	DRAWN	CHK'D	APP'D	DESCRIPTION	ISSUE	DATE	DRAWN	CHK'D	APP'D	DESCRIPTION
A	MAR20/09	JE	PW	CB	ISSUED FOR TENDER						

DESIGNED PW
DRAWN JE
CHECKED PW

Dayton & Knight Ltd.
CONSULTING ENGINEERS
#210-888 HARBOURSIDE DR., NORTH VANCOUVER, B.C. V7P 3S1
TEL: (804) 990-4800 FAX: (804) 990-4805 www.dayton-knight.com

VILLAGE OF QUEEN CHARLOTTE
HONNA RIVER WATER SUPPLY - WATER TREATMENT PLANT
PIPING PROFILES

SCALE: 1:100
DRAWING No. 163.008.004
SHEET No. G10 ISSUE A
THIS DRAWING REDUCED TO HALFSIZE

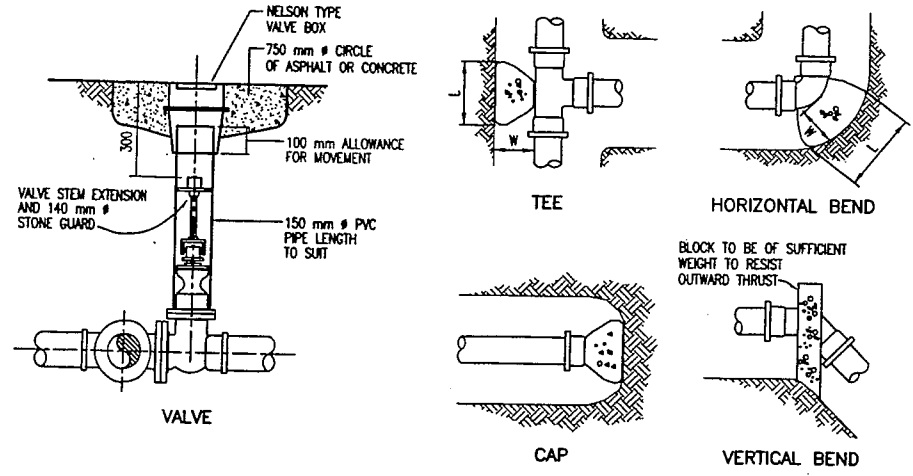

MINIMUM THRUST AREAS FOR FITTINGS AT 1030 kPa PRESSURE AND FOR SOILS WITH MIN. BEARING OF 96 kPa (NOT TO BE USED FOR SOFT CLAY, MUCK, PEAT ETC.)

TYPE OF FITTING	FITTING SIZE	OUTSIDE OF FITTING TO BEARING FACE	LENGTH	HEIGHT	TYPE OF FITTING	FITTING SIZE	OUTSIDE OF FITTING TO BEARING FACE	LENGTH	HEIGHT
	D	W	L	H		D	W	L	H
90° BEND	100	300	300	300	CAPS AND PLUGS (IF NOT BOLTED)	100	300	300	300
	150	300	920	460		150	300	460	460
	200	350	1070	610		200	350	610	610
	250	380	1450	760		250	380	760	760
TEE	100	300	300	300	300	400	920	920	
	150	300	610	460					
	200	350	760	510					
	250	380	990	740					
	300	400	1220	920					

DIMENSIONS APPLY TO THE LARGER DIAMETER END OF FITTING.

THRUST BLOCKS
NOT YET CALCULATED

NOTES:
(1) H = DEPTH OF IMPORTED MATERIAL IN MILLIMETRES.
O.D. = PIPE OUTSIDE DIAMETER IN MILLIMETRES.
TOP OF TRENCH = H/6 + 600 + O.D. WIDTH (mm).
(2) ALL UNITS ARE IN MILLIMETRES (mm) UNLESS OTHERWISE SHOWN.

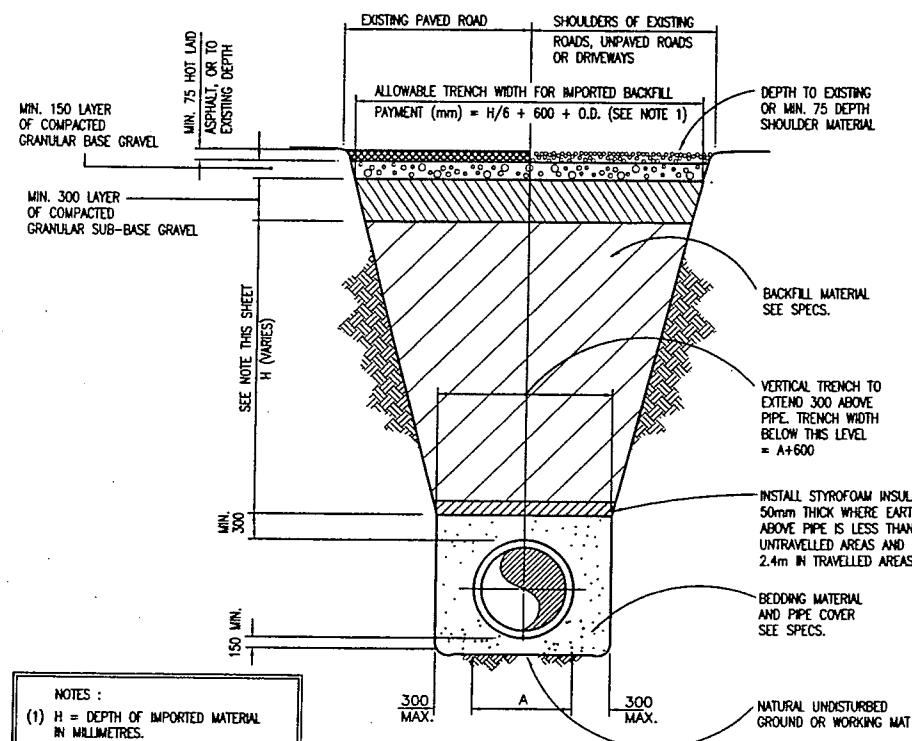

TRAVELLED ROADS AND ROAD R/W
TRENCH-GRANULAR-BED

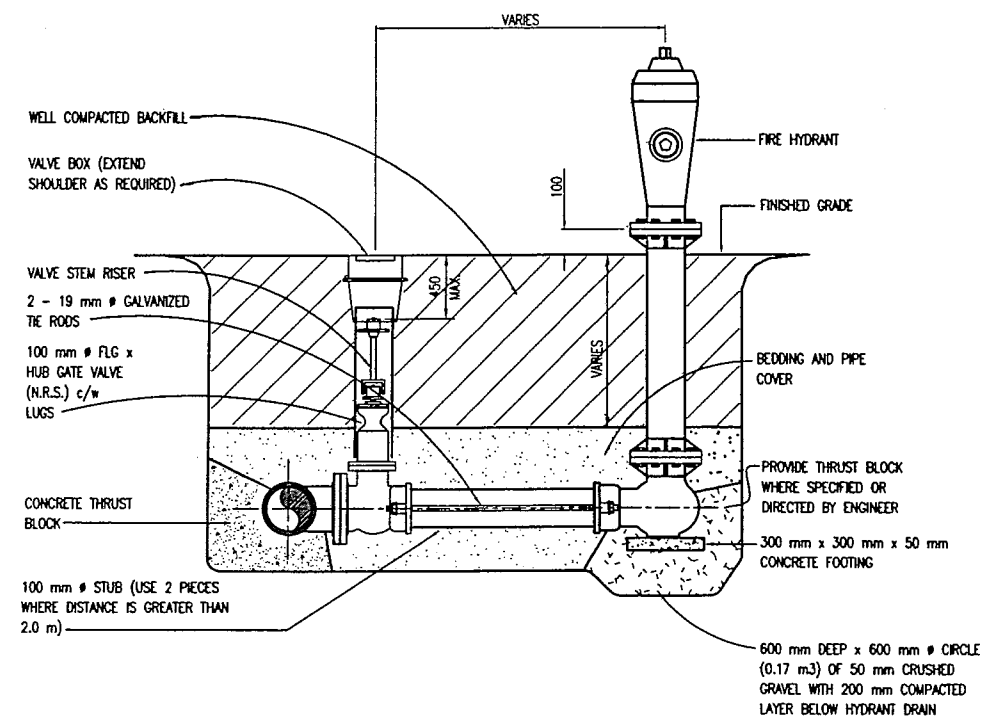

FIRE HYDRANT ASSEMBLY

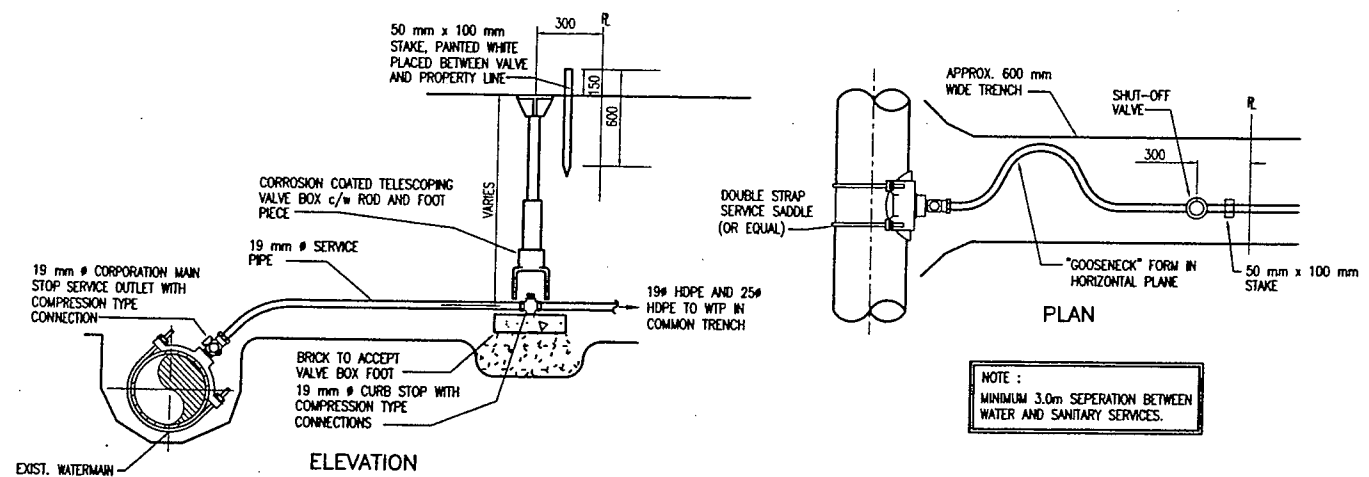

WATER SERVICE CONNECTION

NOTE:
MINIMUM 3.0m SEPARATION BETWEEN WATER AND SANITARY SERVICES.

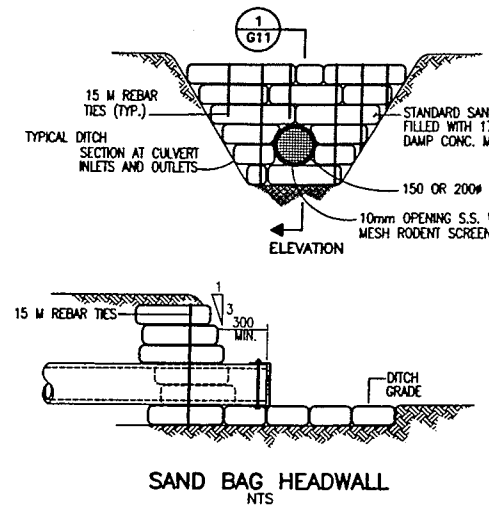

SAND BAG HEADWALL
NTS

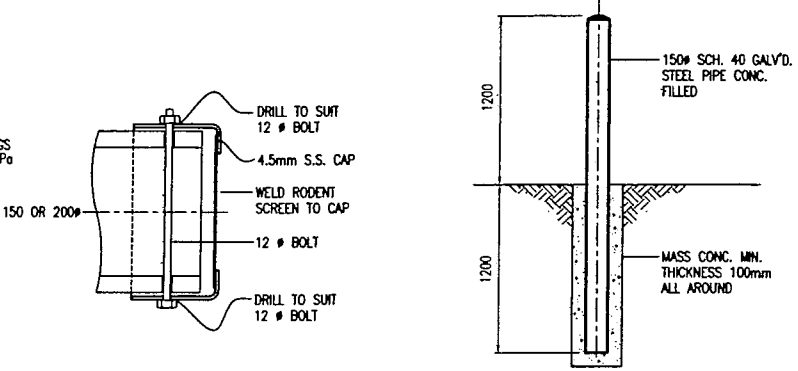

BOLLARD DETAIL
NTS

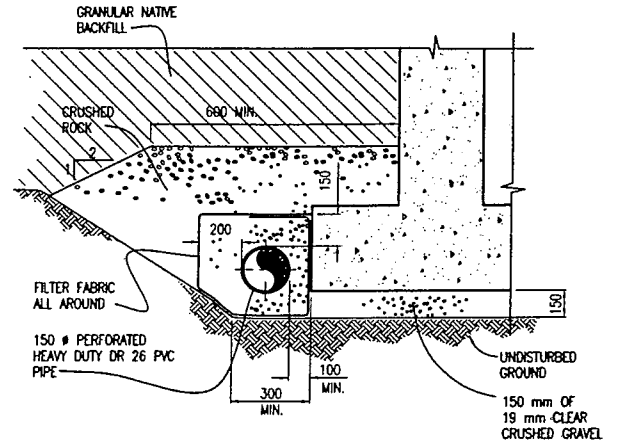

TYPICAL FOUNDATION DRAIN DETAIL

FILE: P:\Drawing\GREEN - CHARLOTTE\163-8-4-2\GENERAL\163.8.4-WTP-G3-G11 - CIVIL-2009.dwg Tab: G11 09-03-19 DCURTISS

PLOT: FULL 1:1 HALF 1:2

ISSUE	DATE	DRAWN	CHK'D	APP'D	DESCRIPTION	ISSUE	DATE	DRAWN	CHK'D	APP'D	DESCRIPTION
A	MAR20/09	JE	PW	CB	ISSUED FOR TENDER						

DESIGNED PW
DRAWN JE
CHECKED PW

Dayton & Knight Ltd.
CONSULTING ENGINEERS
#210-889 HARBOURSIDE DR., NORTH VANCOUVER, B.C. V7P 3S1
TEL: (604) 990-4800 FAX: (604) 990-4805 www.dayton-knight.com

VILLAGE OF QUEEN CHARLOTTE
HONNA RIVER WATER SUPPLY - WATER TREATMENT PLANT
DETAILS

SCALE: NTS
DRAWING No. 163.008.004
SHEET No. G11 ISSUE A
THIS DRAWING REDUCED TO HALFSIZE